

28MM 670X295 CM ZDDDC01 (ART 3601EXT)

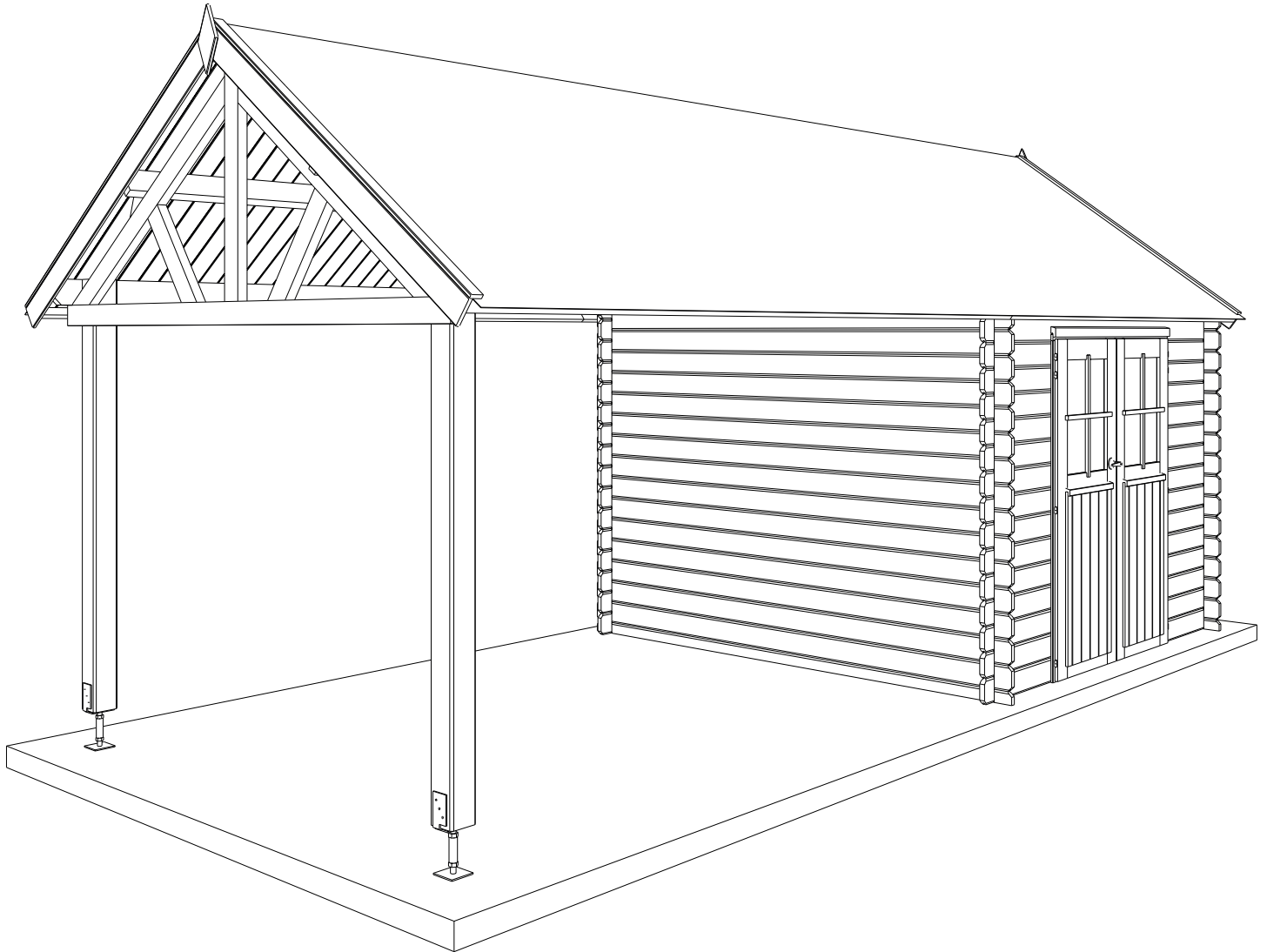

GARDENAS

TIMBER GARDEN CONSTRUCTIONS

GEDETAILLEERDE ONDERDELENLIJST

-

LISTE D'INVENTAIRE DETAILLEE

Onderdelenlijst
Liste d'inventaire

Typ
diamond

28mm 295x295 cm ZDDDC01

3601

Artikel nr / Dimension # Functie/Fonction
Nr Article A B C

Wandelementen / Eléments des parois

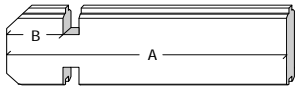

C1/739/0100 739 100 (-) 28 naast deur voorgevel / côté porte façade

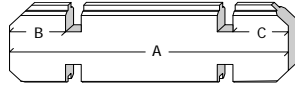

C3/2950/0100/100 2950 100 100 45 achter- en zijgevel / paroi latérale & arrière

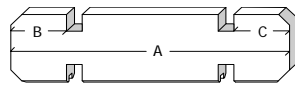

C5/2950/0100/100 2950 100 100 2 bovenste plank achter- & voorgevel /
planche supérieure paroi arrière & façade

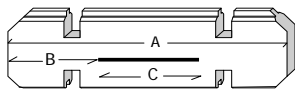

C8/2950/0739/1472 2950 739 1472 1 boven deur / au-dessus porte

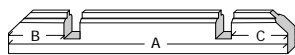

C7/2950/0100/100 2950 100 100 2 basis zijgevel / base paroi latérale

Dakelementen / Eléments du toit

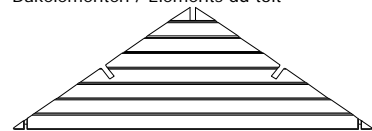

CK/S/2950/3/4 2950 (-) (-) 2 puntgevel te assembleren / pignon à assembler
(8 planken/planches)

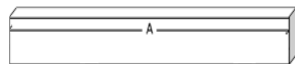

P4/2950/0100/100 2950 100 100 3 dakbalk / poutre du toit



DP/1900 1900 (-) (-) 58 dakplanchet / planchette du toit

Afwerkingselementen / Eléments de finition



SRD/1502 1502 (-) (-) 2 sierlat boven deurenkader / latte de finition cadre de porte



FSL/1920 1920 (-) (-) 4 frontale sierlat / latte de finition frontale



SSL/1920 1920 (-) (-) 4 stormsierlat op het dak / Latte de finition sur le toit



S (-) (-) (-) 2 schildje / ecusson



ZSL/2950 2950 (-) (-) 2 Zijsierlat tegen dakplanchet /
finition latérale contre planchette du toit

Dubbele Deur + Deurenkader / Porte double + chassis

A/DDC01 1

Beslag / Quincaillerie

BESLAG/31 1

Pakken Shingles / Pacquets de Bardeaux

3184P/1-8 5

Onderdelenlijst
Liste d'inventaire

Typ
diamond

28mm 375x295 cm ZDVSP

3600AB375

Artikel nr / Dimension # Functie/Fonction
Nr Article A B C

Dakelementen / Eléments du toit

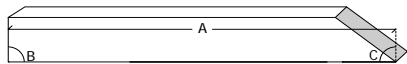

P1R2/0126/90/53 126 90 53 2 dakbalksteun / échantignole
P1R2/0526/90/53 526 90 53 2 buitenste hangstijl / contrefiche

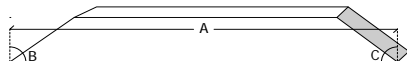

P1R2/1560/36/53 1560 36 53 2 spantbeen / arbalétrier

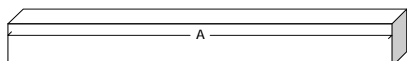

P1/0967 967 (-) (-) 1 middenste hangstijl / poinçon

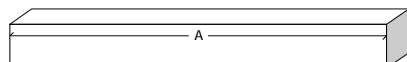

P1/2694 2694 (-) (-) 1 hanebalk / entrait

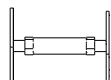

P4/3700 3700 (-) (-) 3 dakbalk / panne

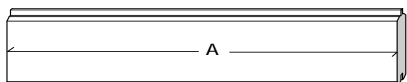

P4/3800 3800 (-) (-) 2 ligger / traverse

S44/025/0100 100 25 44 3 opvulstukje / pièce pour boucher (voor/pour ref 3603EXT)

S120/120/2000 2000 120 120 2 paal / poteau

UA/120/120 290 120 120 2 U-anker / U-socle

DP/1900 1900 (-) (-) 68 dakplanchet / planchette du toit

Afwerkingselementen / Eléments de finition

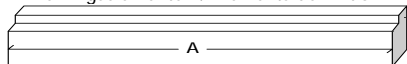

ZSL/3700 3700 (-) (-) 2 Zijserlat tegen dakplanchet /
finition latérale contre planchette du toit

Beslag / Quincaillerie

BESLAG/36 1

Pakken Shingles / Pacquets de Bardeaux

3184P/1-8 5 (6 voor/pour ref 3602EXT375)

28MM 295X295 CM ZDDDC01 (ART3601)

VOORZIJDJE - FACADE

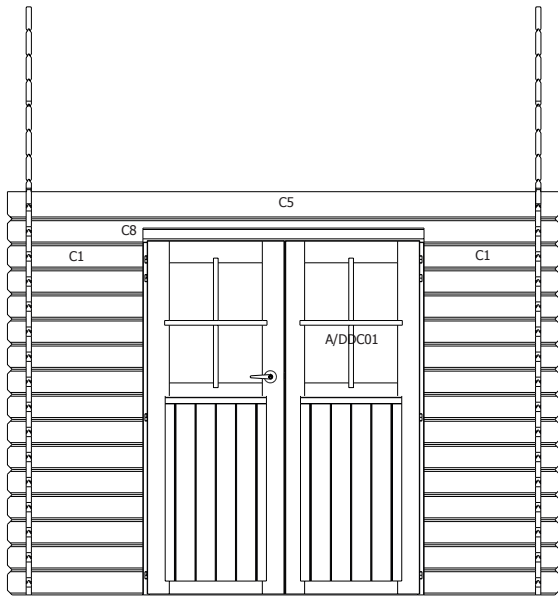

RUGZIJDJE - PAROI ARRIERE

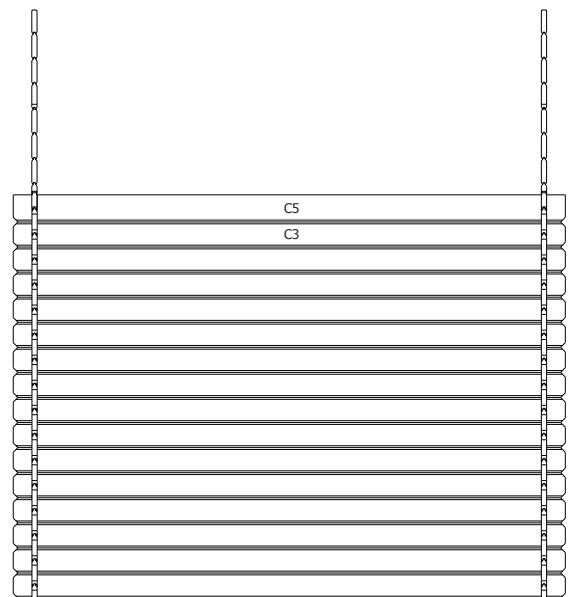

ZIJWAND - PAROI LATERALE

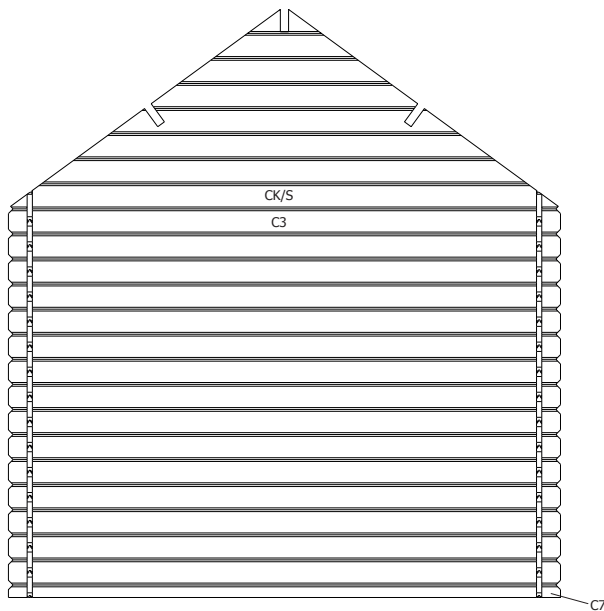

ZIJWAND - PAROI LATERALE

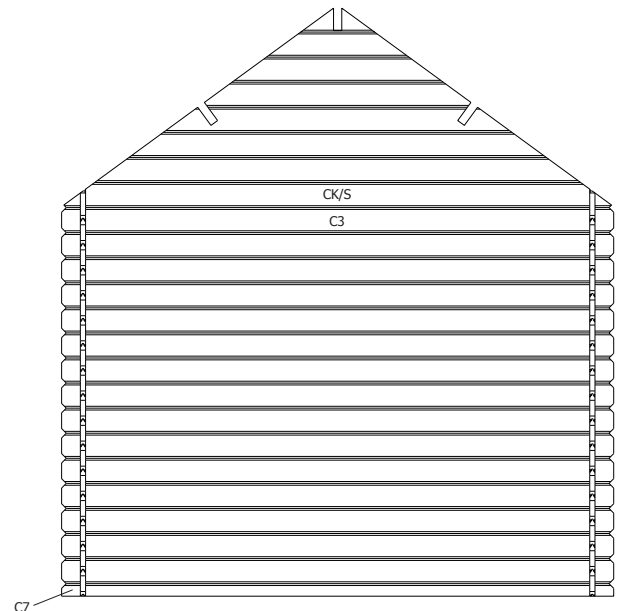

DAK - TOITURE

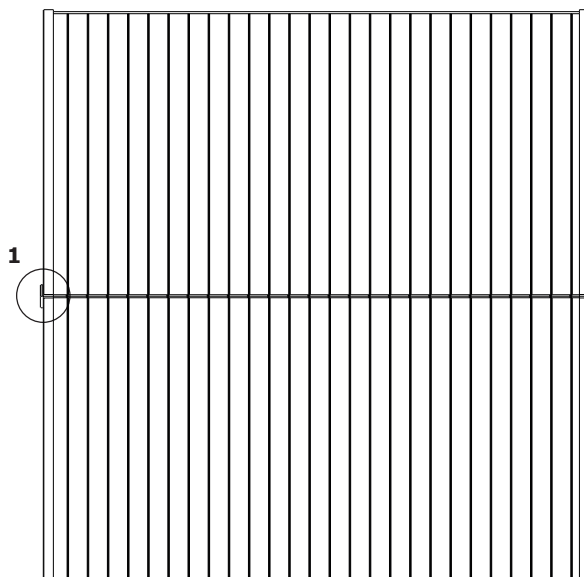
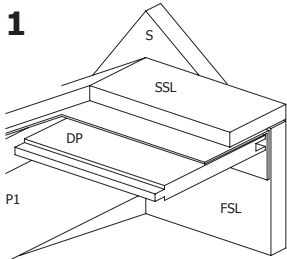

28MM 375X295 CM ZDVSP (ART 3600AB375)

ZIJAANZICHT - VUE LATERALE

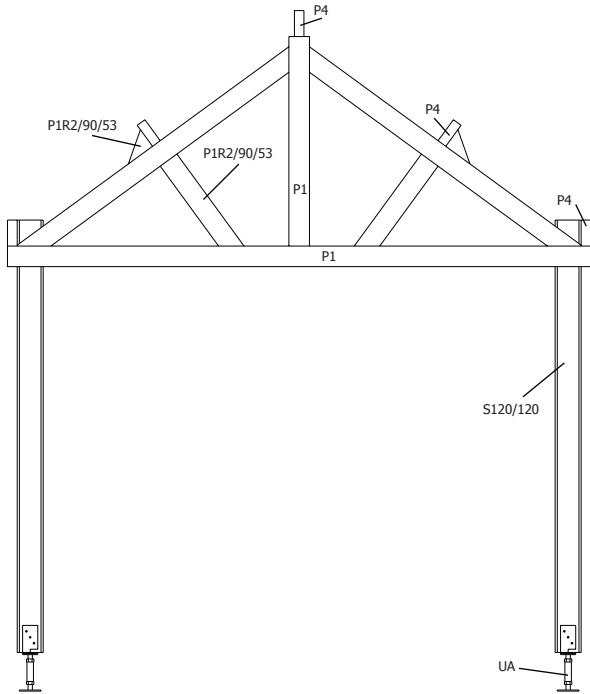

VOORZIJDE - FACADE

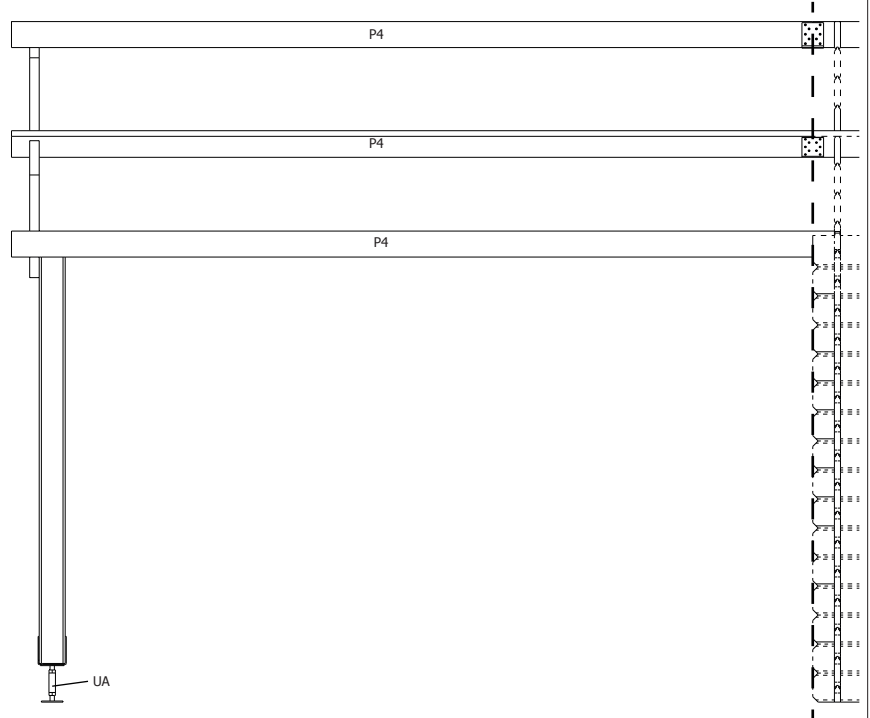

DAK - TOITURE

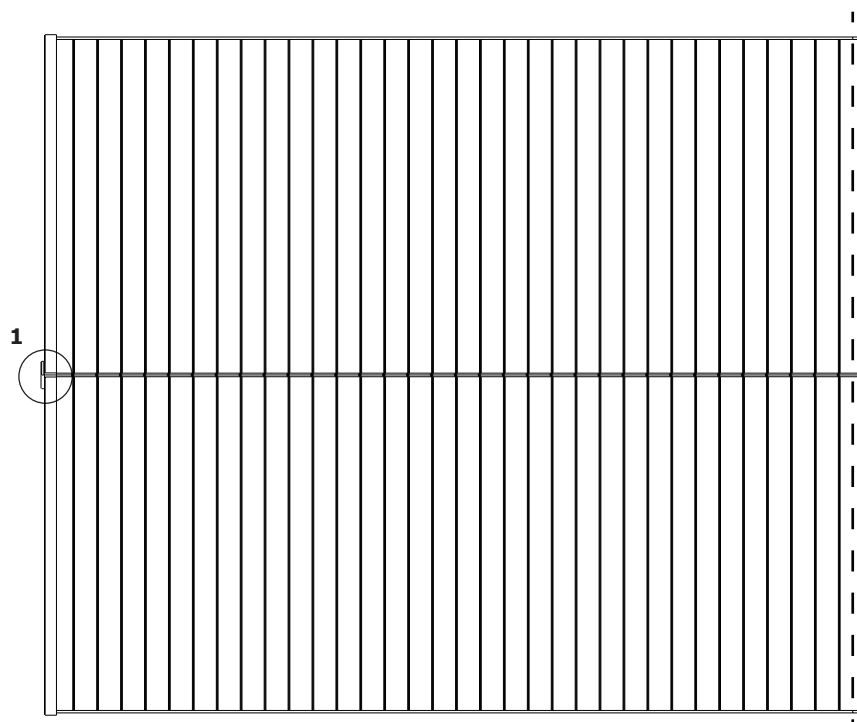
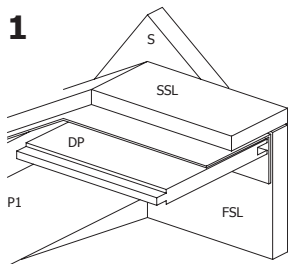

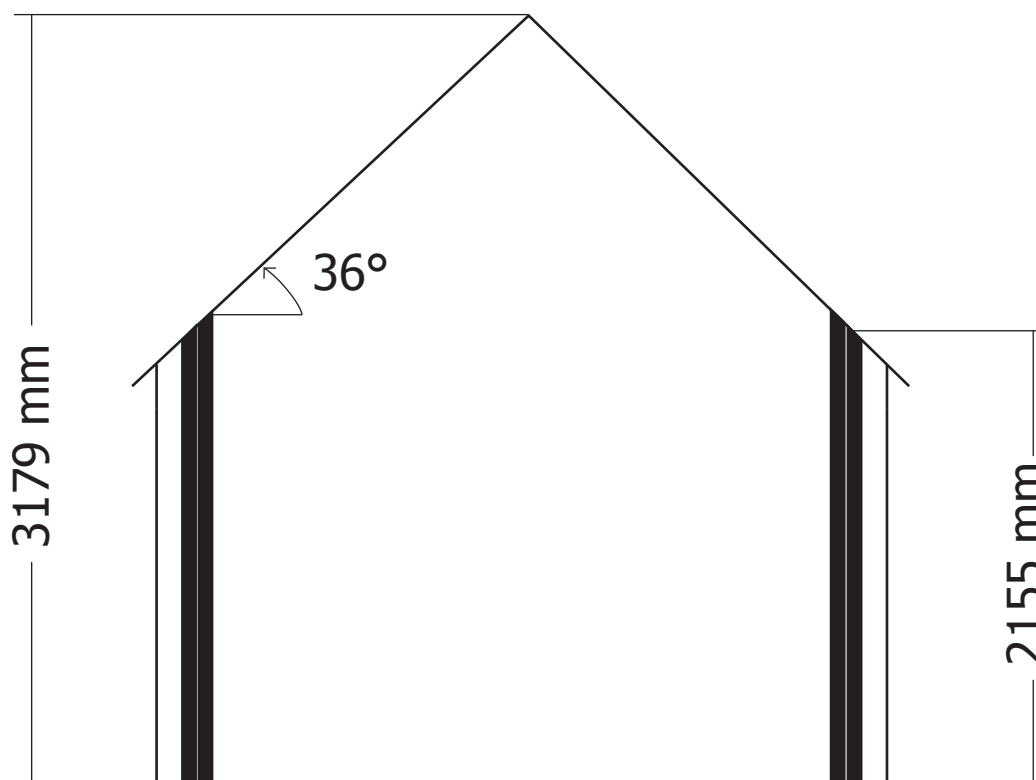
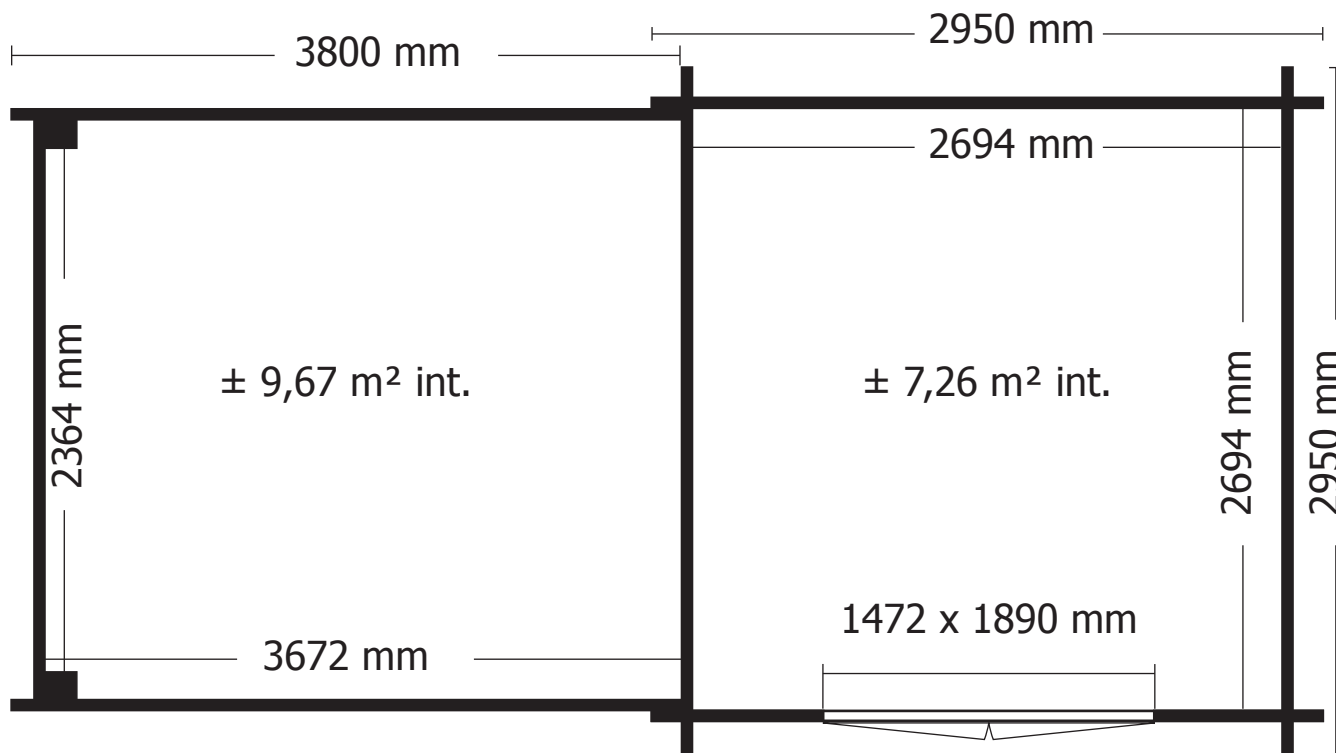

OPGELET : Behandel **ELK** onderdeel grondig aan alle zijden met een degelijk product dat beschermt tegen zon, weer en wind en tegen insecten en schimmels, **VOOR** de montage.

ATTENTION : Traitez à fond **CHAQUE** élément avec un produit protégeant contre les intempéries, les insectes et les moisissures intérieur et extérieur, **AVANT** le montage .